

THE INFORMATION CONTAINED IN THIS DRAWING IS THE SOLE PROPERTY OF CAMBRIDGEPORT AIR SYSTEMS. ANY REPRODUCTION IN PART OR WHOLE WITHOUT THE WRITTEN PERMISSION OF CAMBRIDGEPORT IS PROHIBITED.

SUBMITTAL

CAMBRIDGEPORT POWER EXHAUST

CASPWREXH001A (#1002132)

Carrier:

48/50 GJ, HJ, TJ, TF, TM 004-007
 48/50 TC 04-07, 50 TCQ 04, 05, 06, 07
 48/50 HC 04, 05, 06, 50HCQ, 04, 05, 06
 48 HE 003-006

Bryant:

580 & 558D, F 548D, 551 & 581B 036-072
 548J, 558J, 580J, 04, 05, 06
 548C, D, F, 551A, B, 558C, D, F 036-072
 580C, D, F, 581A, B, 549B 036-072

CASPWREXH002A (#1002134)

Carrier:

48/50 GJ, HJ, TJ, TF, TM 008-014
 48/50 TC, 08, 09, 12, 14, 50 TCQ 08, 09, 12
 48/50 HC, 07, 08, 09, 12, 50 HCQ 07, 08, 09

Bryant:

548C, D, F, 551A, B, 558C, D, F 580C, D, F, 581A, B, 549B 090-150
 558J, 580J 08, 09, 12, 14,
 551J, 581J 07, 08, 09, 12
 548J 08, 09, 12, 549J 07, 08, 09,

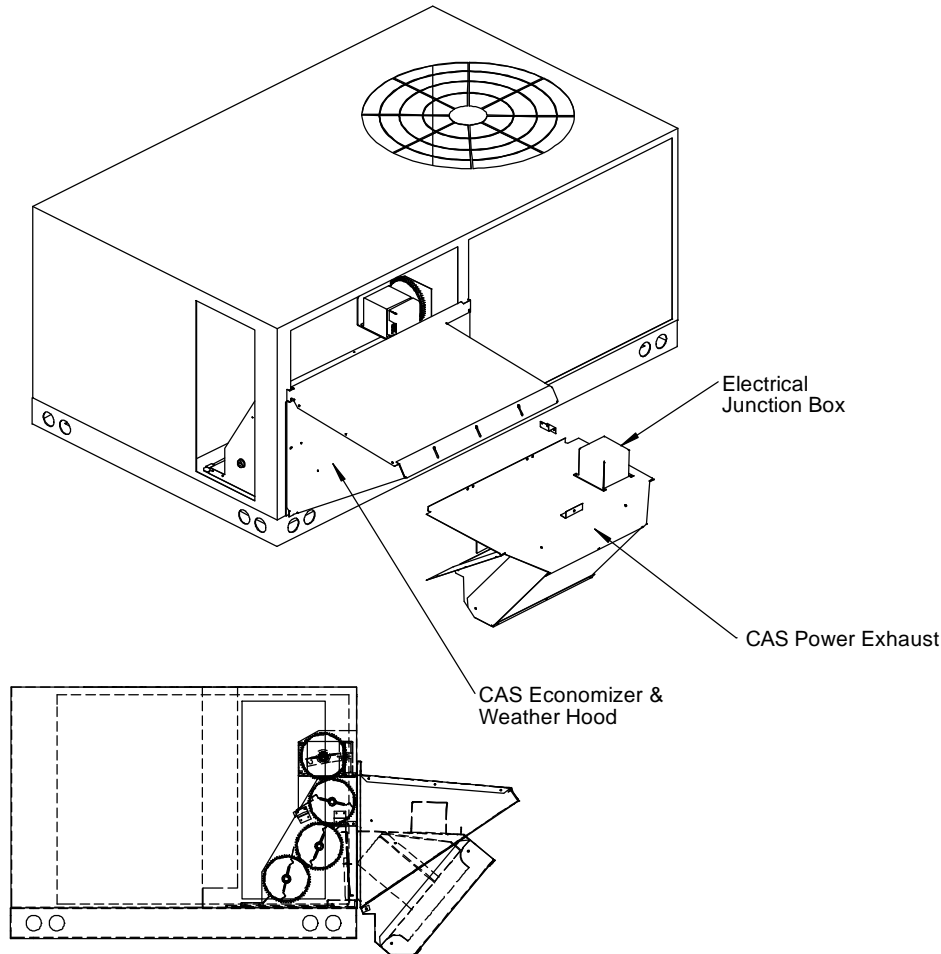

Features:

Power Exhaust is constructed of 18 gauge galvanized steel and is shipped fully assembled

New moisture eliminating filter provided

Exterior surfaces color matched to HVAC unit

Fans are maintenance free, AMCA certified and

UL-705 "Power Ventilators" labeled

Can be used with standard 14" tall roof curb

All necessary hardware and instructions included

APPROVAL

Submitted to:

Company:

Job Name:

Equipment:

Approved by:

Date:

Unit Size	CAS Part Number	Voltage	Full Load Amps (FLA)	Performance			
				1/8"	1/4"	3/8"	1/2"
3 - 6 Ton	CASPWREXH001A	208-230-460-3-60	1.3 - 1.2 - .65	1160	1110	920	730
7.5 - 12.5 Ton	CASPWREXH002A	208-230-460-3-60	1.3 - 1.2 - .65	2970	2280	1830	1490

Cambridgeport™

HVAC Accessories & Engineered Systems

8 FANARAS DRIVE

PH(800)-648-2872 SALISBURY, MA 01952 FAX(978) 462-9189

DESCRIPTION

CASPWREXH001A_, 2A

SIZE DWG. NO.

A Power Exhaust Submittal Sheet

SHEET 1 OF 1