

# ROOF CURB ASSEMBLY INSTRUCTIONS

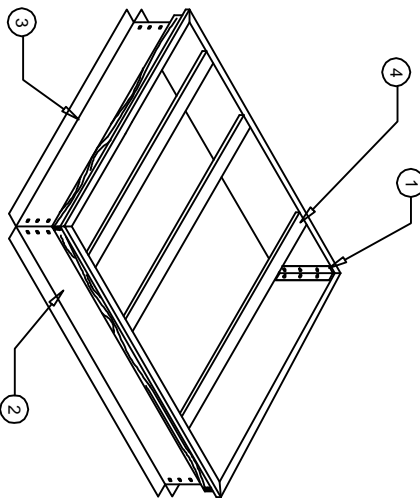

## PARTS LIST

- ① CORNER BRACKET (QTY. 4)
  - ② END RAILS (QTY. 2)
  - ③ SIDE RAILS (QTY. 2)
  - ④ DUCT SUPPORT (QTY. 3)
  - ⑤ HARDWARE BAG (QTY. 1)
- (12) 10-16 x 3/4" TEK SCREWS  
 40 FT. 1-1/4" x 1/4" GASKET  
 (16 NUTS & BOLTS

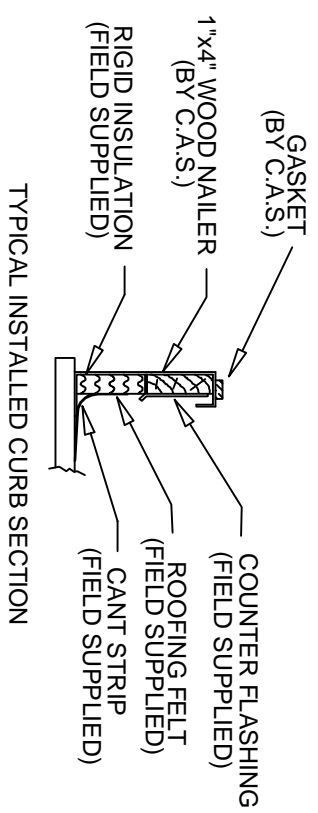

TYPICAL INSTALLED CURB SECTION

AAON UNITS  
 PART NUMBER  
 AAON CAMBRIDGEPORT  
 CABINET C 1003850

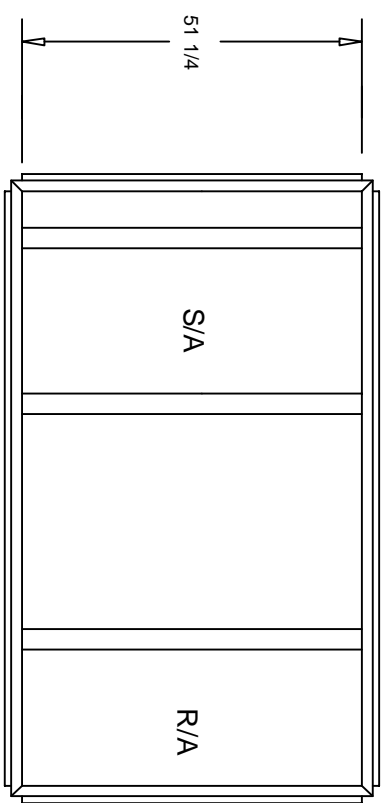
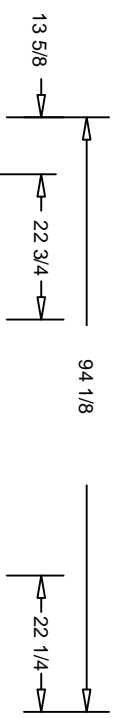

DATE:07-11-01 REV:00

SEE REVERSE SIDE FOR STEP-BY-STEP ASSEMBLY INSTRUCTIONS.

CAMBRIDGEPORT AIR SYSTEMS, INC.  
 SALISBURY, MA 01952  
 PHONE 1-800-648-2872 FAX 978-462-9189