

DATE: \_\_\_\_\_  
 COMPANY: \_\_\_\_\_  
 JOB NAME: \_\_\_\_\_  
 SUBMITTED BY: \_\_\_\_\_  
 NOTES: \_\_\_\_\_

# ROOF CURB SUBMITTAL #1014563

CARRIER 48TC\*D24-28  
 CURB ASSEMBLY NUMBER  
 1014563

Drawn By: RTO  
 Drawn Date: 6-12-09

REV:

**ESTIMATED WEIGHT: 275 LBS.**

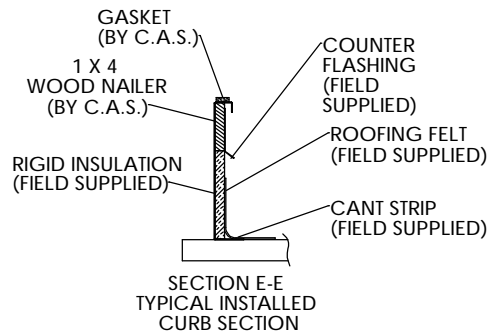
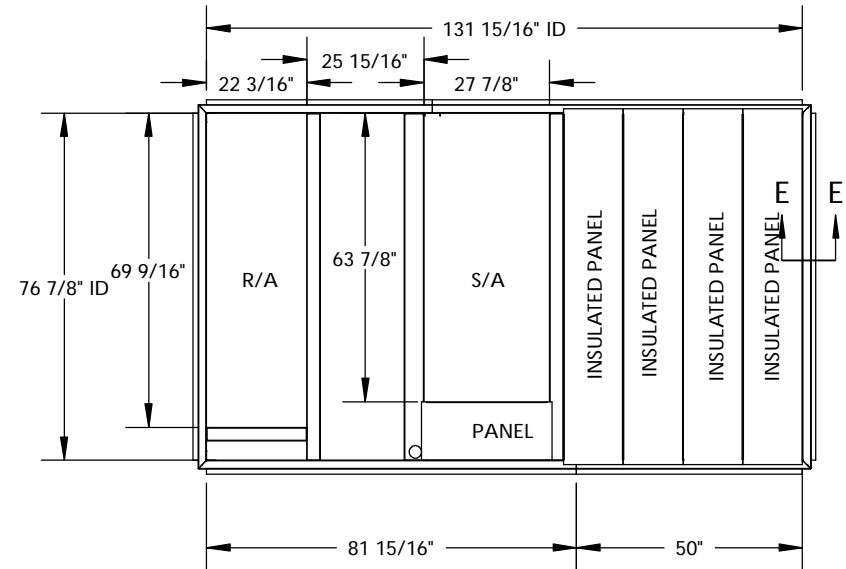
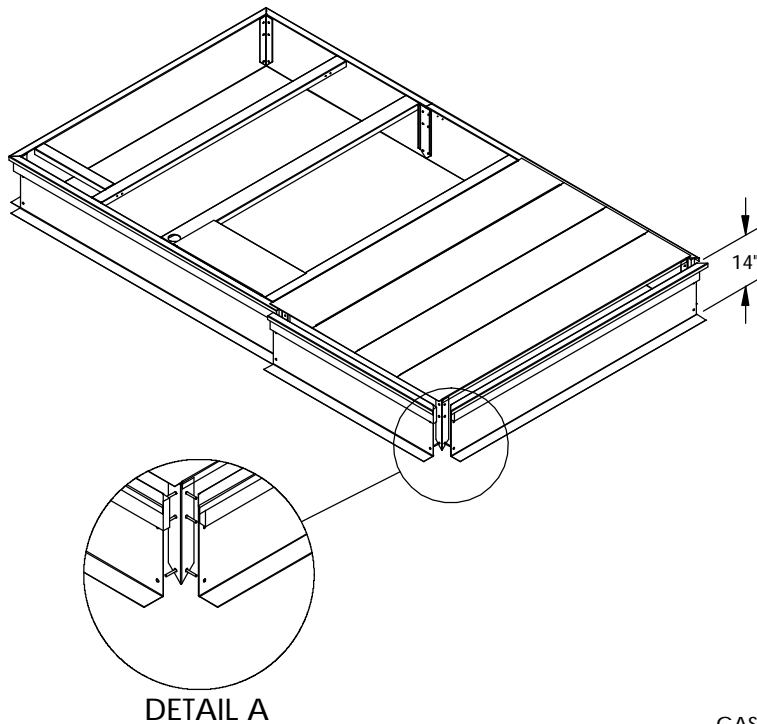

**FEATURES:**

- MITERED TOP CORNERS
- ROOF CURB BODY IS FABRICATED OF HEAVY GAUGE GALVANIZED STEEL.
- FULL PERIMETER WOOD NAILER.
- PRE-PUNCHED ASSEMBLY HOLES AND HARDWARE INCLUDED FOR DUCT SUPPORT INSTALLATION,
- GASKETING PROVIDED FOR UNIT TO CURB SEALING.
- ROOF CURB IS SHIPPED KNOCKED DOWN.
- ROOF CURB IS SEISMIC RATED.

ROOF CURB IS LABELED WITH RTU# IF APPLICABLE

© 2007 COX ENGINEERING COMPANY  
 DBA CAMBRIDGEPORT AIR SYSTEMS. ALL RIGHTS RESERVED TM

## Cambridgeport

### AIR SYSTEMS, INC.

SALISBURY, MA 01952  
 PHONE 1-800-648-2872 FAX 1978-462-9189