

SUBMITTAL

REVISIONS					
REV	ECN #	DESCRIPTION	APP	CHKD	DATE

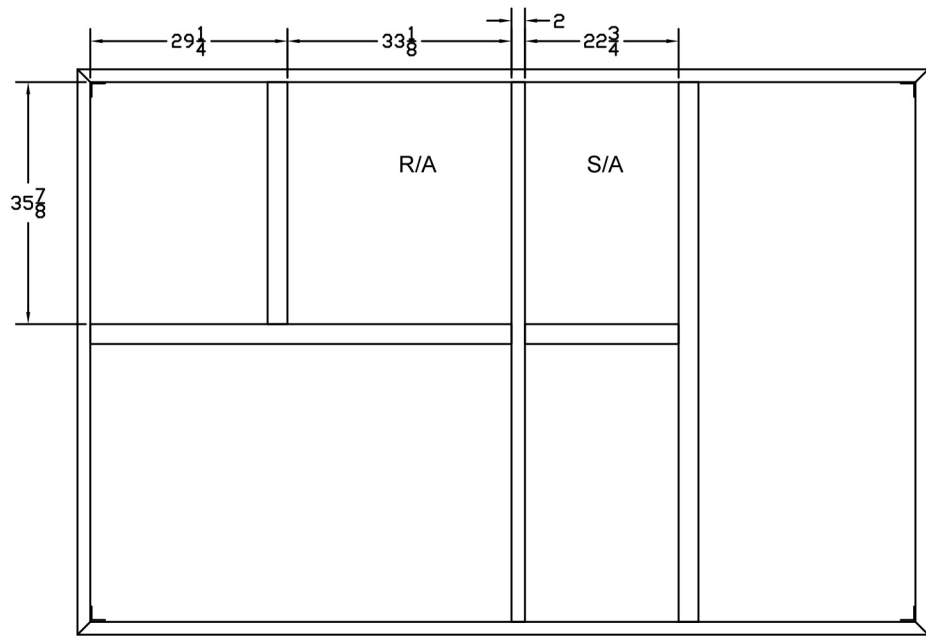

TOP VIEW

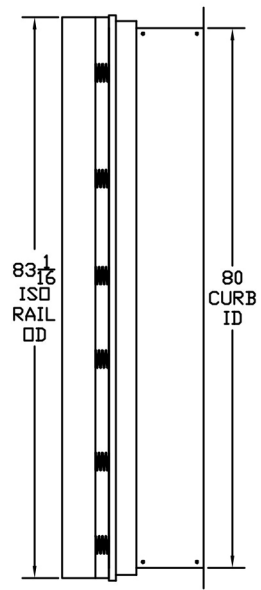

RIGHT VIEW

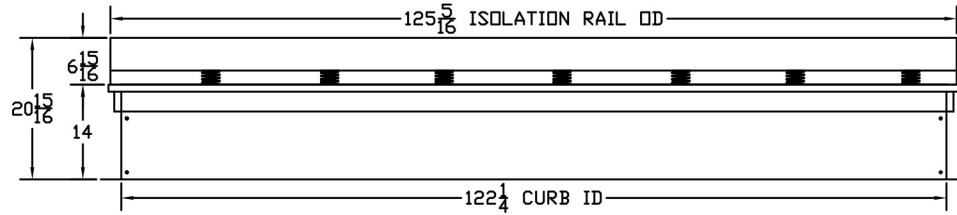

FRONT VIEW

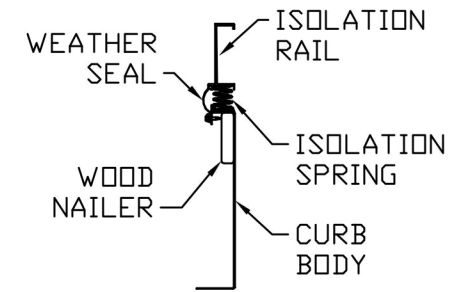

FEATURES:

1. CURB AND ISOLATION RAIL SHIPPED FULLY ASSEMBLED
2. ISOLATION RAIL FABRICATED OF ALUMINUM EXTRUSION
3. CURB FABRICATED OF HEAVY GAUGE GALVANIZED STEEL
4. CURB BODY IS ***** CONSTRUCTION
5. FULL PERIMETER WOOD NAILER INCLUDED
6. FULL PERIMETER WEATHER SEAL INCLUDED
7. DUCT SUPPORT INCLUDED
8. CANVAS DUCT NOT INCLUDED

Approved: _____

Date: _____

YORK : XP180-240
ISOLATION CURB W/ 1" DEFLECTION

Cambridgeport TM			
1-800-648-2872			
HVAC Accessories & Engineered Systems			
DESCRIPTION		CURB, ISOLATION, YORK	
		SUBMITTAL	
CUSTOMER/JOB NAME			
JOB#		DATE	
SCALE		PAGE	
DRAWN BY		DWG #	1021986
CHECKED BY		(EMS #)	

THE INFORMATION CONTAINED IN THIS DOCUMENT IS PROPRIETARY TO CAMBRIDGEPORT AIR SYSTEMS. THIS DOCUMENT MAY NOT BE ISSUED TO ANOTHER PARTY WITHOUT PRIOR WRITTEN CONSENT AND AUTHORIZATION. * CAMBRIDGEPORT* AND THE CAMBRIDGEPORT LOGO ARE REGISTERED TRADEMARKS OF CAMBRIDGEPORT AIR SYSTEMS. ALL RIGHTS RESERVED.

TOLERANCES: DECIMALS: .000 = +/- .063, .00 = +/- .063, .0 = +/- .063 ANGLES: +/- 1 DEG FRACTIONS: +/- 1/16"